

U-K Series

#EnergySaving / #ProtectingMotor / #Durability

Construction / Mining Submersible Pumps



• Saving energy
Designed for high efficiency, this series pumps have smaller motor output and less power consumption than the other series with the same performance.

• Heavy-duty
Major parts such as motor frame are made of cast iron which has excellent durability in various tough situations.

In addition, impeller is made of ductile cast iron or high chrome cast iron, and casing is made of thick cast iron. These parts are mainly designed for great resistance against sediment-mixed water.

• Compact design
This series pumps are designed as small as possible in size to be used in a narrow space and at a low water level.

Even in the condition the motor is exposed to air, the structure of single water channel can cool the motor with lifted water passing through the channel.

• Diverse usage
It is useful for drainage not only at construction sites but also at facilities in factories.

◆ Applications

- Drainage in construction sites / mining / manholes / underground / underground parking space etc...
- Drainage of puddles / spring water
- Drainage facilities in factories
- Agricultural / Industrial water supply and drainage

◆ Performance Curve

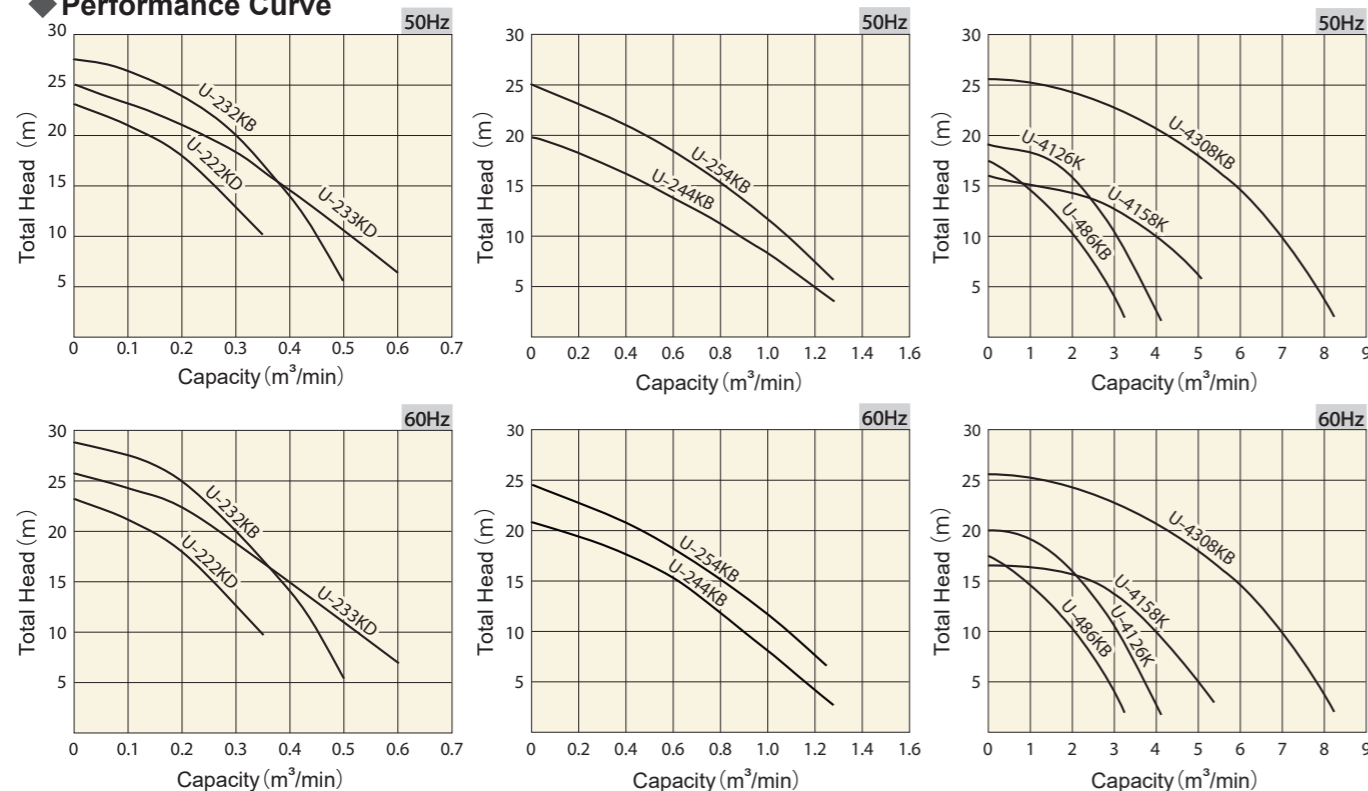

◆ Main Specifications

Discharge Diameter (mm)	50	50	80	100	100	150	150	200	200	
Pump Models	U-222KD	U-232KB	U-233KD	U-244KB	U-254KB	U-486KB	U-4126K	U-4158K	U-4308KB	
Motor Output (kW)	1.5	2.2	2.2	3	3.7	5.5	9	11	22	
Medium	Type	Rain Water / Spring Water / Muddy Water								
	Temperature	Max 40 Degrees Celsius								
Pump	Shaft Seal	Double Type Mechanical Seal								
	Shaft Bearing	Sealed Ball Bearing								
	Impeller	*FCD	High Chrome				*FCD			
	Casing	*FCD				*FC				
Motor	Type/Pole	Dry Type Induction Motor / 2pole				Dry Type Induction Motor / 4pole				
	Insulation Class	F				B	F	B	F	
	Protector	Auto-cut								
	Frame	*FC								
	Shaft	Stainless Steel								
Discharge Type		Hose Coupling								

*FCD : Ductile Cast Iron / FC : Cast Iron

◆ Specifications

Discharge Diameter (mm)	Pump Models	Motor Output (kW)	Total Head (m)	Capacity (m³/min)	Starting	Max Solid Through (mm)	Weight (kg) *Without Cable	Cable Length (m)
50	U-222KD	1.5	18	0.2	DOL	11	28	10
50	U-232KB	2.2	20	0.3	DOL	11	31	10
80	U-233KD	2.2	14	0.4	DOL	11	31	10
100	U-244KB	3	10	0.9	DOL	12	46	10
100	U-254KB	3.7	12	1	DOL	12	58	10
150	U-486KB	5.5	10	2	DOL	20	124	10
150	U-4126K	9	16	2	DOL	20	180	10
200	U-4158K	11	10	4	DOL	20	200	10
200	U-4308KB	22	20	4	DOL	20	335	10

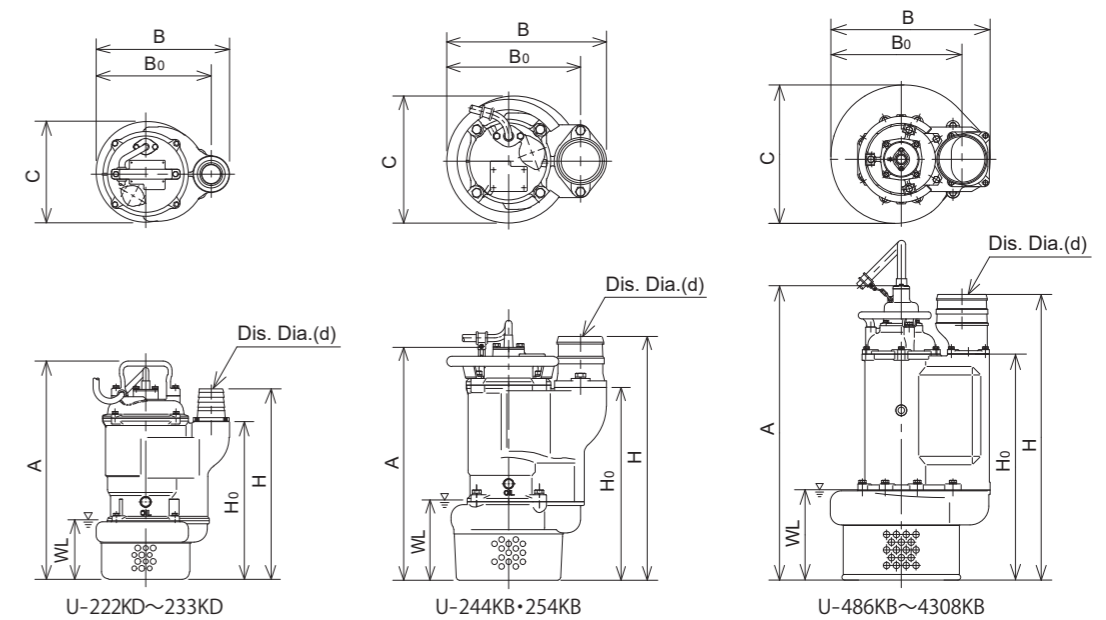

◆ External Diagrams (mm)

Pump Models	d	H	H ₀	A	B	B ₀	C	WL
U-222KD	50	384	318	440	269	232	204	120
U-232KB	50	408	338	460	288	242	204	120
U-233KD	80	439	338	460	288	242	204	120
U-244KB	100	516	408	493	338	283	268	170
U-254KB	100	516	408	493	338	283	268	170
U-486KB	150	747	553	743	457	376	381	250
U-4126K	150	807	613	788	540	459	481	300
U-4158K	200	849	617	792	543	437	483	300
U-4308KB	200	1,107	876	1,140	617	508	537	350

WL : Pump Starting Level

Construction / Mining Submersible Pumps